

SHP-DP728

USER MANUAL

Samsung SDS Digital Door Lock

Convenient Opening

Easy push/pull handle access

Welcome Function
When a user gets close to the door lock, the authorization standby mode will automatically activate.

Silent-Mode Function
When going in or out, the sound of the key entering and door opening will be suspended.

Automatic Card Reading Function
When a card touches the reader, the reader will conveniently recognize the card.

Double Authorization
Requires password & fingerprint combination to open

Security Assurance Function
When someone is inside the house, authorization for entry from the outside will be prohibited.

Built-in Fire Detection
Generates alarm in case of a fire

Security Function
Prevents intrusion from the outside

Smartphone Interworking function
Conveniently open the door through the Bluetooth function of a smart phone

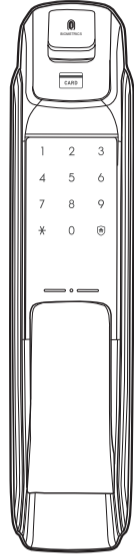

www.samsungsds-nss.com/en

GC68-02163A ED:02

Safety Cautions



Warning

This section contains important information to ensure the user's safety and prevent potential damage to property. Please, read this section carefully and use the product accordingly.

- The user shall not install or repair the product without authorization.
- Do not install the product in the place where the gap between the door and the frame is 5mm or more.
- Make sure that no unauthorized person has the access to the password.
- Do not operate the product with wet hands, and keep liquids such as water or drinks away from the product, or the product may malfunction or be damaged.
- Do not use the excessive force or sharp objects to push the lockbuttons, as this can damage the product.
- Make sure that the door is completely closed when going outside. The manufacturer does not assume the responsibility for any harm caused by engagement of the lock on an improperly closed door.
- Please do not hang on the product or pull it.
- Long-term exposure to direct sunlight may cause a crack on its touch pad. Avoid exposure to direct sunlight during installation.
- During battery replacement, use a new one instead of the existing battery.
- Be sure to correctly match the poles (+/-) when installing the batteries. Install the batteries with the correct poles (+/-).
- Do not use water, benzene or alcohol when cleaning the product, as these fluids can cause product malfunction.
- Replace the batteries within 1 week after the battery replacement alarm sounds.
- Interference in wireless communication may occur when this product is used.
- According to the wireless communication environment, its battery may consume much.

Product Components

The product components used may vary depending on the installation environment.

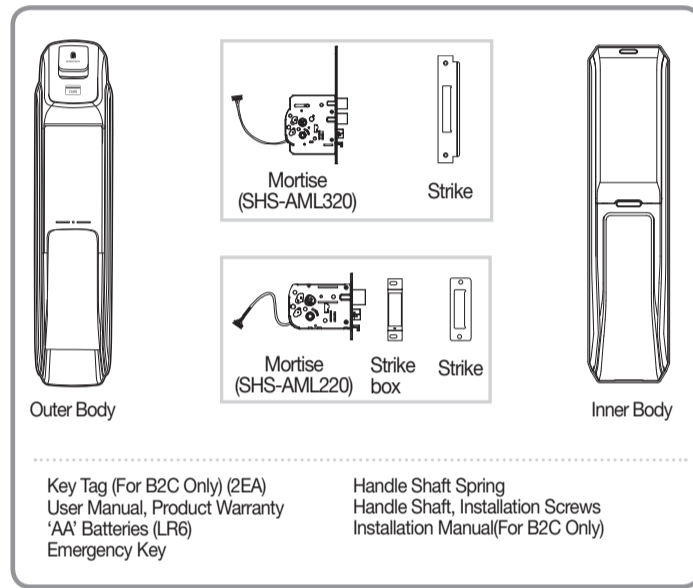

Key Tag (For B2C Only) (2EA)
User Manual, Product Warranty
"AA" Batteries (LR6)
Emergency Key

Handle Shaft Spring
Handle Shaft, Installation Screws
Installation Manual(For B2C Only)

Outer Body Parts

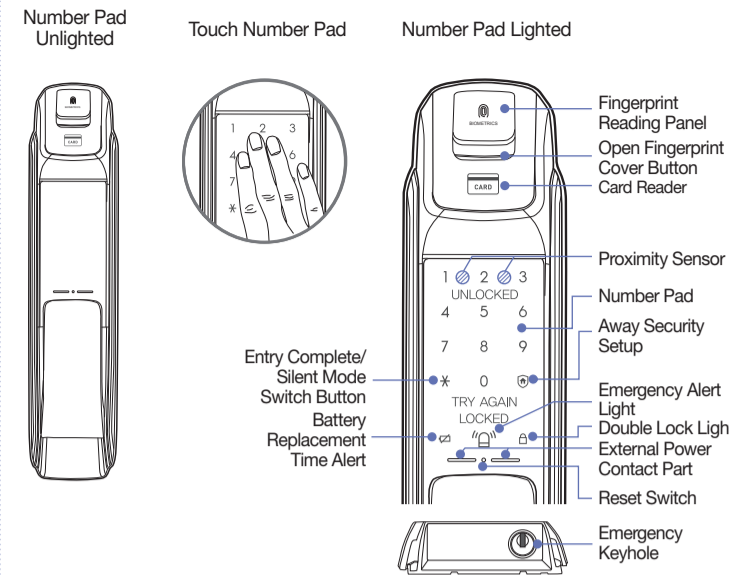

Inner Body Parts

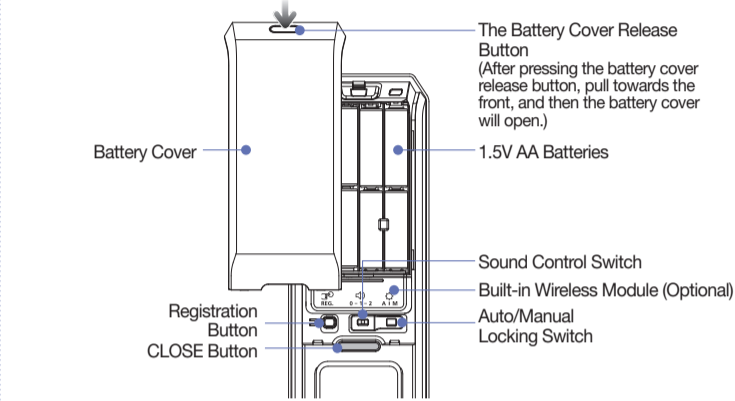

Mortise

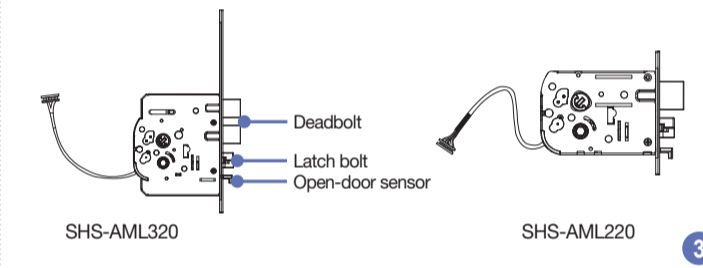

Opening the Door from Outside with a Password

When purchased, the product is set to Multi-leveled Security Code Entry Mode initially. Please refer to "Multi-leveled Security Code Entry Mode setting" for Common Mode setting.

※ Silent Mode

Before entering the password, press the [*] button and enter the password, then both the sound of the key entering and the door opening will be suspended. It is a useful function if you do not want to disturb neighbors when you go in and out at night.

Multi-leveled Security Code Entry Mode

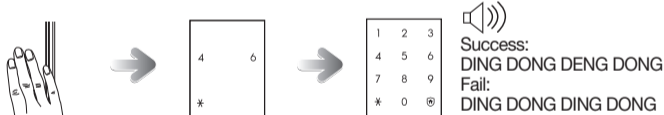

Touching [Number Pad] will light up the number pad. When two arbitrary buttons are lighted, press the buttons in order. When the numbers on the number pad are lighted, enter the password and press the [*] button.

- If the security mode is changed as 'common mode', second step will be skipped.

- Note**
- Password must be entered after the light is on, and if does not, touch [Number Pad] and re-enter.
 - To cancel, press [0] button and re-enter.
 - If the password is wrong 5 times, "beep" warning alarm will sound 20 times and the system will shut-down for about 3 minutes. When malfunction happens, "beep" will sound every 10 seconds, and stop mode will be turned off automatically after 3 minutes with multiple 'beeps'.

Opening the Door from the Outside with a Fingerprint

Open the door from the outside using the fingerprint authentication system. Touch the sensor properly with the fingerprint part of your finger which has been registered.

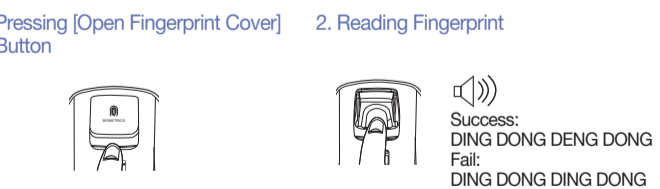

Press the [Open Fingerprint Cover] button and the lid of the Fingerprint Reading Panel opens. Touch the Fingerprint Reading Panel with the registered fingerprint after LED light turns on, the lid of the panel closes in approximately a second later. Then push the door handle to open the door.

Opening the Door from Outside with a Card or Key Tag

The door can be opened from outside using a card or key tag. Place the registered card or key tag on the card reader.

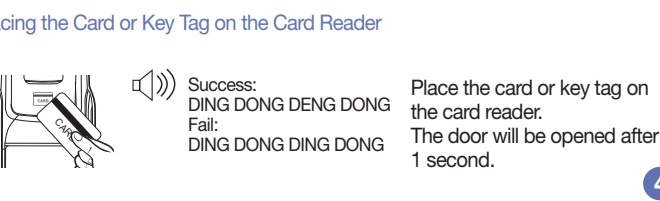

Opening the Door from the Inside

Available in both a push-pull or pull-push
Depending on the direction of the door installed in the residence, customer can choose from either push-pull type or pull-push type on purchase.

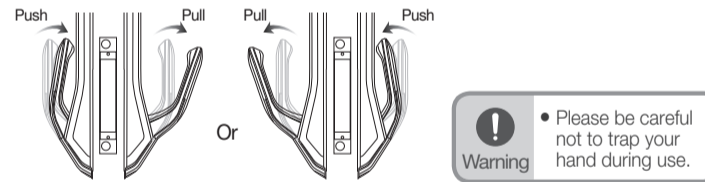

Closing the Door from the Inside

Automatic Locking Setting
The door is automatically locked 1 seconds after the door is closed.

Manual Locking Setting
The door is locked when the [Close] button is pressed.

- Note**
- To check if the door is locked from the inside, press the security button briefly; the red LED will flash if the door is locked and the blue LED will blink if the door is unlocked.
 - For 5 seconds after the door is closed, the Bluetooth authentication mode is not turned on even though you approach the door lock. (Note that the Bluetooth mode is turned on when you touch the number pad.)

Initialization (Password, Fingerprint, Bluetooth, Card, Key Tag)

All registered data (password, Fingerprint, Bluetooth, card, key tag) are deleted. After initialization, the password is set to '1234', and the registered card, key tag data are erased. Please register a new password after initialization.

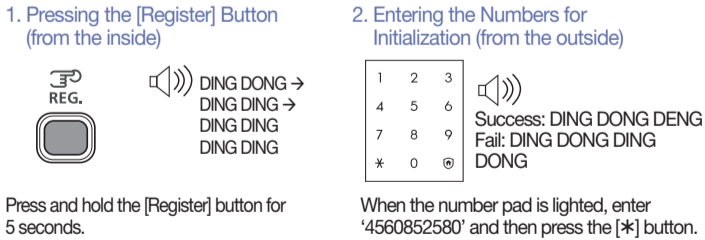

Press and hold the [Register] button for 5 seconds. When the number pad is lighted, enter '4560852580' and then press the [*] button.

Activation/Deactivation of the Bluetooth Mode

After the Bluetooth mode is activated, accessing the door lock from the outside or touching its number pad can authenticate the registered Bluetooth smart-phone to open the door. The Bluetooth mode is activated by default.

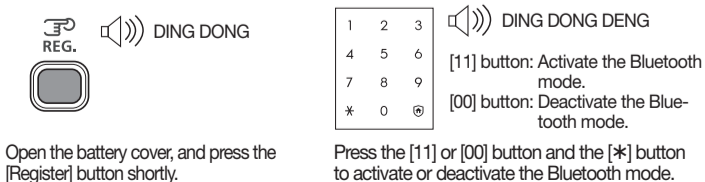

- Note**
- For the information on the pair/unpair of a Bluetooth smart phone, see the description of application use.
 - Only smart phones with iOS 7.1 or higher and Android 4.3 or higher support this function. Whether to support Bluetooth, see the App description.

Fingerprint, Card and Key Tag Registration

You can register and use up to 100 fingerprints. Up to 20 cards, including the key tag, can be registered. (Only ISO14443 A Type is available.)

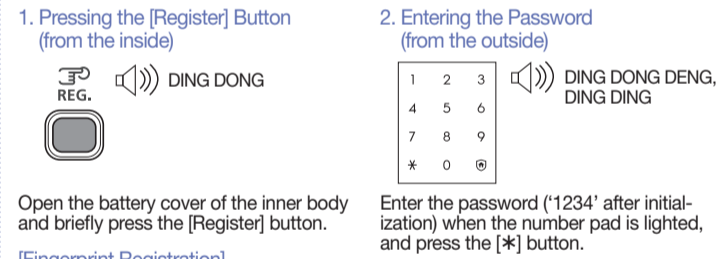

Open the battery cover of the inner body and briefly press the [Register] button. Enter the password ('1234' after initialization) when the number pad is lighted, and press the [*] button.

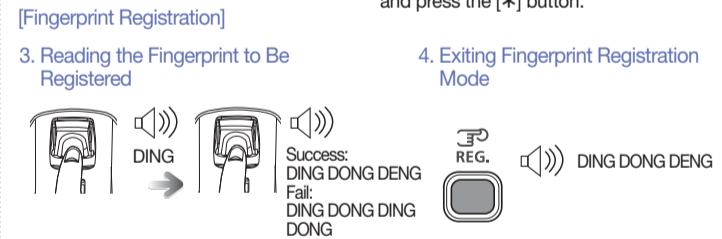

When LED light on the Fingerprint Reading Panel is on, touch the panel with the fingerprint to be registered. When a "ding" sound is heard and LED light goes off, then remove the finger. (Must do it 3 times) To end the registration, please press the [Registration] button on the inner body.

[Card and Key Tag Registration]

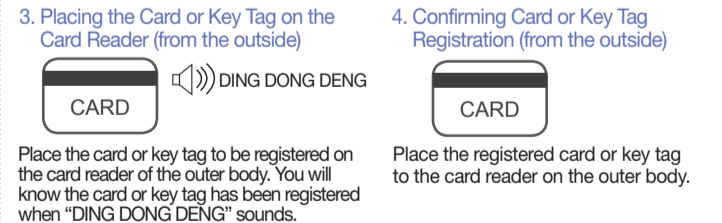

- Warning**
- To register multiple cards or key tags, lightly place another card or key tag to the card reader within 20 seconds after registering the previous card or key tag.

Pairing of a smart phone

Up to eight compatible smart phones can be paired. To pair multiple smart phones, turn off the Bluetooth of a paired smart phone, and pair another smart phone. If a Bluetooth smart phone registered is lost, replaced, or repaired and its information cannot be deleted from the door lock, the door lock should be initialized.

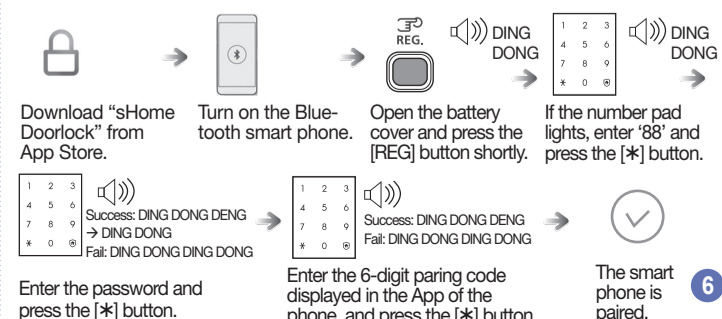

Deleting Registered Fingerprints & Cards

You can delete individual or all registered fingerprints and cards.

1. Pressing the [Register] Button (from the inside)



Open the battery cover of the inner body and briefly press the [Register] button for 3 seconds.

[Deleting Fingerprints]

3. Reading the Fingerprint to Be Deleted

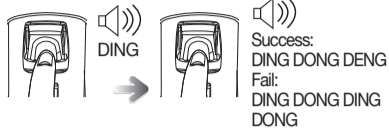

When LED light on the Fingerprint Reading Panel is on, touch the panel with the fingerprint to be deleted.

[Deleting All Fingerprints]

3. Entering the number (from the outside)

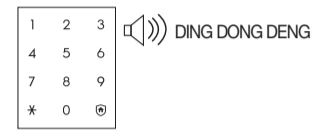

If you want to delete all fingerprints, press [7] + [*] after step 2.

2. Entering the Current Password (from the outside)

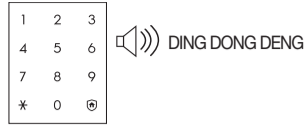

Enter the current password when the number pad is lighted, and press [*] button.

4. Exiting Fingerprint Deletion Mode



To end the deletion mode, press [Registration] button.

[Deleting All Cards]

3. Entering the number (from the outside)

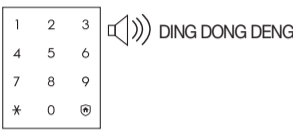

If you want to delete all cards, press [8] + [*] after step 2.

Security Assurance Mode Activation/Deactivation

At-home security mode is to prevent opening of the door from outside while someone is inside.

Security Assurance Mode Activation



While the door is locked, press [CLOSE] button on the inner body part for 3 seconds.

Security Assurance Mode Operation



Rapid beeping

- When the security assurance function is activated, the door cannot be unlocked from the outside, so please be careful. Be especially careful not to allow children to set this mode accidentally from the inside.

Security Assurance Mode Deactivation

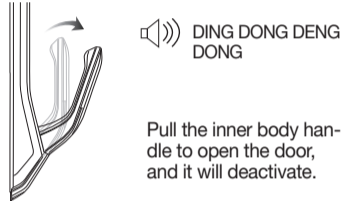

Pull the inner body handle to open the door, and it will deactivate.

Double Authorization Mode Setting

You can delete Double authorization mode requires both fingerprint and password to open the door, ensuring more security. To setup the double authorization mode, one or more fingerprints must be registered.



Briefly press the [Register] button on the inner body.

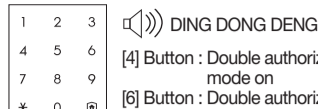

Press the [*] button after pressing the [4] or [6] button, and the authorization mode will be set.

Two-factor Authentication Mode Operation

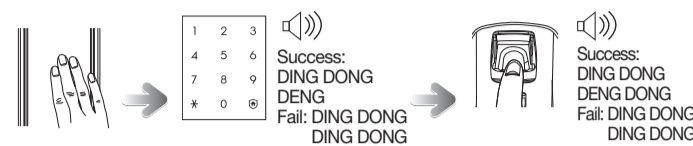

Touching [Number Pad].

Enter the password when the number pad is lighted, and press the [*] button.

Touch a registered fingerprint on the Fingerprint Reading Panel. After a successful authentication, the door opens.

Password Change

The password can be 4~12 digits number. Only one password can be registered.

1. Pressing the [Register] Button (from the inside)



Open the battery cover of the inner body and briefly press the [Register] button.

3. Entering a New Password (from the outside)



Enter the new password (4 to 12 digits) and press the [*] button.

2. Entering the Current Password (from the outside)



Enter the current password ('1234' after initialization) when the number pad is lighted, and press the [*] button.

4. Checking New Password Operation (from the outside)



To make sure the password has been properly registered, check the new password and close the door.

- Manage your password with care so that unauthorized people will not have access to it. Regularly changing your password can reduce the risk of it being leaked.

Set up Instructions for Alarm and Anti unlock functions

Alarm function

When this function is activated, an alarm sound and light will turn on for approximately 5 minutes duration.

Anti-Bypass function

When this function is activated, the internal handle will become tightened to prevent bypass attempts through door edge tools will be minimized.

Set up the Alarm function

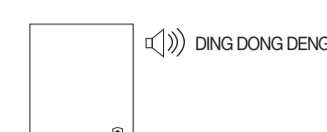

When the door is closed, user can set up the alarm function by pressing and holding the [0] button for 3 seconds until sound confirmation.

Set up the Anti-Unlock function

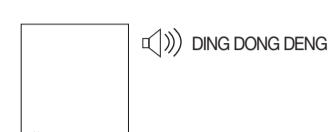

Press [*] and hold. After 3 seconds, the alarm will be come active.

Release the Alarm function

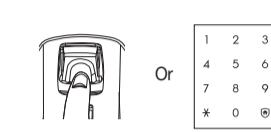

After touching the Number Pad, have a registered fingerprint read, or contact a registered card, or enter the password and then press the [*] button.

Release the Anti-Bypass function

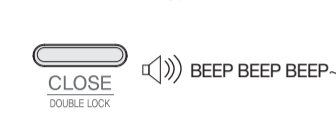

Press the [CLOSE] button to release the internal handle from Anti-Bypass function. When this function is active, it may be harder to pull the internal handle for elderly or children to open the door from inside.

- Warning: Anti-Bypass function should only be set up when there is no one inside.

Sound Setting and Releasing

The sound that is generated when the number buttons are pressed, when the door is locked or when the locked door is unlocked, can be set according to the user's preference. The product is set to generate all sounds at the factory.

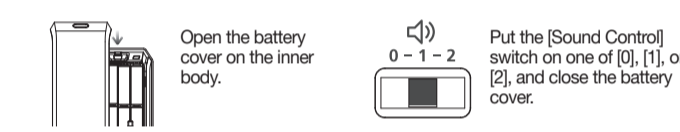

- [0] Button: All sounds except the alarm sound are deactivated.
- [1] and [2] Buttons: All sounds are activated and the sounds get bigger as the step become higher.

Welcome Function On/Off

The welcome function is a convenient function that automatically activates the authorization standby mode when a user approaches the door, even before touching the number pad.



Open the battery cover and press [Registration] button briefly.



- [1]+[*] button: Welcome function on, the one-minute alarm function on
- [2]+[*] button: Welcome function on, the one-minute alarm function off
- [3]+[*] button: Welcome function off
- [5]+[*] button: Set up fingerprint Authentication standby mode
- [8]+[*] button: Clear Fingerprint Authentication standby mode

On and Off / Function Description

- Welcome function on: The mode will automatically activate the authorization standby mode when a user approaches the door lock.
- Welcome function off: The mode will authorize a user when the user enters the password on the number pad or connects a card to the number pad.
- One-minute alarm function on/ off: When someone remains in front of the door lock for more than a minute, this mode will sound the tamper prevention alarm.

- The factory defaults are set with the welcome function on and the alarm function off.
- The working distance of the infrared sensor can differ depending on light conditions and other environments. When the front door is exposed to sun light or constant bright lights it is advised to limit the usage of the sensor as it might sound the alarm.

Multi-leveled Security Code Entry Mode

You can set the security mode suitable for your use when you open the door using a password.



Briefly press the [Register] button on the inner body.



Press the [*] button after pressing the [7] or [9] button, and the security mode will be set.

- [7] Button : Multi-leveled Security Code Entry Mode
- [9] Button : Common Mode

Door Lock Time Setup Function

This function sets the time interval between the moment the door open/closed sensor recognizes the door as closed and the moment deadbolt locks the door. In an environment that the door closes slowly and the deadbolt jams before the door is fully closed, the situation can be fixed by adjusting the door lock time.



Open the battery cover of the inner body and briefly press the [Register] button.

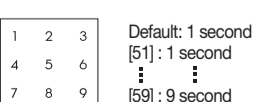

Press [51] ~ [59] button, and then press [*] button.

- Default: 1 second
- [51] : 1 second
- [52] : 2 second
- [53] : 3 second
- [54] : 4 second
- [55] : 5 second
- [56] : 6 second
- [57] : 7 second
- [58] : 8 second
- [59] : 9 second

Automatic/Manual Locking Setting

The Automatic Locking mode allows for automatic locking of the door when it is closed.

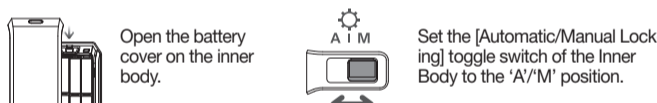

- Automatic: The door is automatically locked 1 seconds after being closed.
- Manual: The door does not lock automatically, and [CLOSE] button must be pressed from the inside, touch [Number Pad] to close the door.

Intrusion Detection Function

This function generates the alarm sound when an attempt is made to forcefully open the door from the inside or the outside. (This is a basic function of the lock, and cannot be separately set or released.) If the door is forcefully opened while locked, the door opening sensor detects it and generates the alarm sound.

Replacing the Batteries

Battery Replacement Alarm Generation

If the melody of "Blues for Elise" sounds when opening the door with the password or a card (key tag), it is time to replace the batteries. (The low battery indicator is lighted when the melody sounds.)

Replacing the Battery

Replace all 8 batteries within a 1 week of the first alarm sound. - The unit will stop operating suddenly if the batteries are not replaced.

- Depending on battery manufacturer, date of manufacture and the user environment, the duration of use may vary. (In the case of average use, given as 10 times a day, 8 AA alkaline 1.5V batteries can last for 10 months.)
- If the poles of the batteries are not placed properly, the lock will not operate normally.
- Liquid leaks from batteries can damage the product. Check the batteries regularly (every 6 months).
- After the battery replacement alarm has sounded, password/card information cannot be registered, changed, deleted, initialized or configured until the batteries are replaced.

Using the Emergency Battery

If the batteries are not replaced after their replacement time comes, they will be completely discharged and the lock will not operate.

Opening the Door Using an Emergency Battery

Purchase an emergency battery (9V) at the nearest store. - As the alkaline batteries offer longer life, they are recommended over the manganese batteries or rechargeable ones.

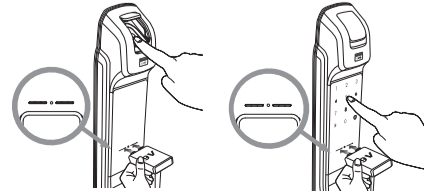

While connecting a 9V battery to the contact point, it is available to use fingerprint, card and password.

Product Specifications

Item	Specifications	
Voltage	AA Alkaline 1.5 Batteries (LR6) 4EA or 8EA (6V)	
Emergency Power Source	9V Battery (6LF22) (Separately sold)	
Operation Method	Electronic Control Method (Password, Fingerprint, Bluetooth, Card, Key Tag)	
Weight	4.1 kg (including both inner and outer bodies)	
Product Dimensions	Outer Body (including the handle)	87.5mm(W) X 391.8mm(H) X 64.5mm(D)
	Inner Body (including the handle)	88.5mm (W) X 357.6mm(H) X 69.3mm(D)

- The contents of this user guide are subject to change without prior notice to the user in order to enhance performance of the product.